



START UP GUIDE

SWIM & EXERCISE SPAS

PREP FOR FILLING

! PLEASE READ ALL INSTRUCTIONS BELOW BEFORE FILLING THE SPA



1 Using a cloth and water, wipe away any dirt/dust collected from transport. Ensure all jets are open by turning the face counter clockwise.



2 Ensure all plumbing and electrical connections are securely connected and tightened as they can come loose during transit.



3 Ensure that any gate/knife valves are fully open.



4 Remove the filter lock ring and lid.

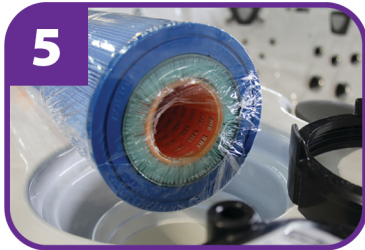

5 Remove filter and take it out of the plastic transport bag. Leave filter canister open when filling.



6 Remove skimmer cavity grate cover by sliding it upwards.



7 Loosen (do not remove) the air bleeder valve located in the skimmer cavity.

FILLING YOUR SPA

! DO NOT USE HOT WATER TO FILL YOUR SPA

! DO NOT USE WATER FROM A WATER SOFTENER

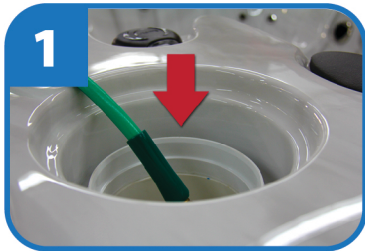

1 Place fill hose into open filter canister and fill hot tub until water is 2/3 of the way up the skimmer opening.



2 When filled all massage jets (excluding neck jets) should be under water.

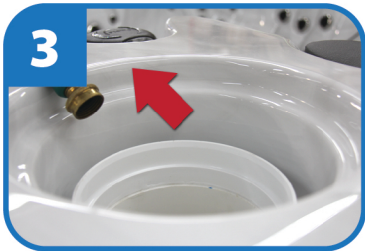

3 Remove fill hose from filter canister.

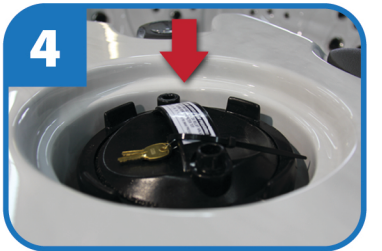

4 Put filter back into filter canister. Then put back on the filter canister lid and tighten locking ring.

POWERING UP YOUR SPA



1 Turn power on at the main breaker.

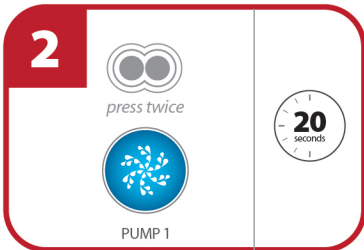

2 Turn pump 1 on high speed for 20 seconds by pressing the pump icon twice.

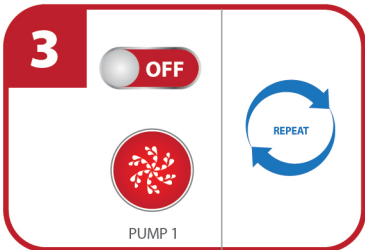

3 Turn pump 1 off by pressing the pump one icon once. Repeat steps 2 and 3 until air is removed from pump 1 and water is coming from jets.



4 Tighten the air bleeder valve located in the skimmer cavity. Set your hot tub temperature. Get ready to enjoy!